

HG604 Series

Hole Diameter Gage

TRULOK
PRECISION MEASURING INSTRUMENTS



STANDARD ADJUSTABLE BASE

A high precision digital gage for quick and accurate measurement of the hole diameter at different depths. This gage has the capability to lock in the position of the probe through a 1.25 inch depth range. The last four digits of the gage part number represent the probe number. The measuring range of the gage's ID probe is $\pm .020$ inch around the nominal diameter stated. The gage body has machined positioning lines spaced equally at .0625 inch intervals for probe depth adjustment. An outer locking base ensures that the operator can check the hole ID at the same depth that the gage has been preset at.

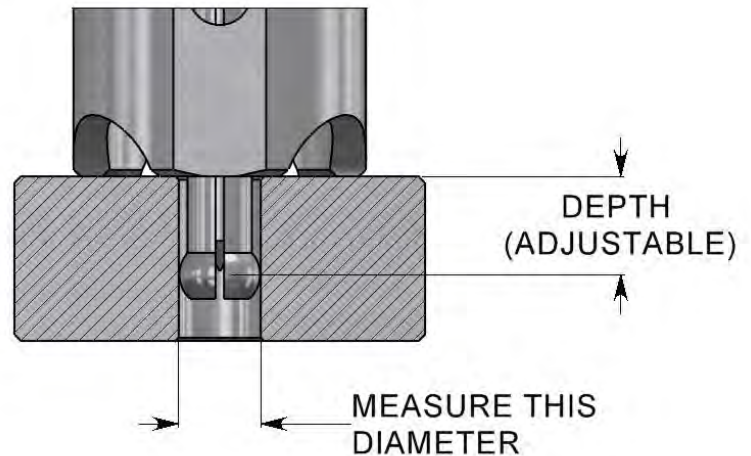

FEATURES

- Measuring accuracy .0001 inch (.0025mm)
- Direct contact inside the hole at any depth
- Direct reading of the bore diameter
- Different base configurations available for curved surfaces
- Accurate, repeatable, and reproducible
- SPC ready via data port cable
- Ease of use with minimal training
- Eliminate costly rework
- Gage and set block calibrated to NIST traceable standards
- Unique serial numbers on gages, set blocks, and indicators
- Components made of heat treated, wear-resistant tool steels and microfinished to ensure accurate and trouble-free operation



DIGITAL INDICATOR'S FEATURES

- LCD display with rotating bezel
- Inch/mm mode toggle capable
- SPC data output ready via data port
- Upper and lower tolerance capable
- Wireless transmission & Bluetooth compatible

ORDERING INFORMATION:

HG604 – **SABX** – **XXXX**

**STANDARD HOLE
GAGE PART NUMBER:
ASSIGNED BY TRIO**

BASE STYLE:
T = TRIPOD
B = BIPOD
Q = QUADPOD
S = SPECIAL

**GAGE VARIANT
CAN BE THE HOLE
DIAMETER, FASTENER
SIZE, OR ANY NUMBER**



TRIPOD



BIPOD



QUADPOD

TRULOK® gages are built to your exact specifications and parameters.

Please supply us with the following data:

1. Hole diameter with tolerances
2. Drilling bushing diameter with tolerance
3. Drilling bushing height and position
4. Ranges of hole diameters to measure
5. Surface curvature

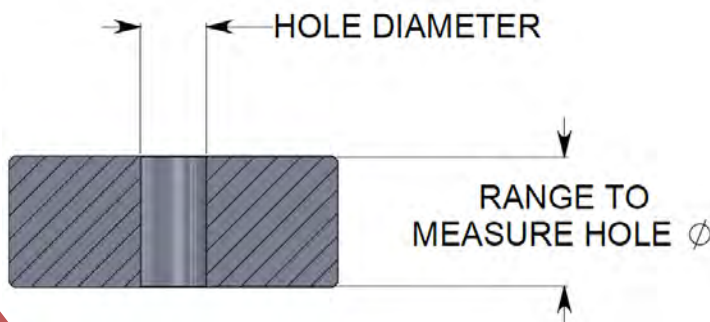

TRULOK HOLE PROBES, SPLIT BALL		Ring set block	
Range (Inch)	Part Number	Model	
.091	.110	TRU-014-A	HD-100
.105	.126	TRU-015-A	HD-1155
.120	.140	TRU-016-A	HD-130
.134	.155	TRU-017-A	HD-144
.149	.169	TRU-018-A	HD-156
.165	.200	TRU-021-A	HD-187
.185	.220	TRU-022-A	HD-203
.209	.244	TRU-023-A	HD-218
.235	.270	TRU-024-A	HD-250
.260	.295	TRU-025-A	HD-281
.288	.323	TRU-026-A	HD-312
.313	.347	TRU-027-A	HD-328
.335	.370	TRU-028-A	HD-359
.360	.394	TRU-029-A	HD-375
.380	.425	TRU-031-A	HD-406
.420	.480	TRU-032-A	HD-437
.474	.531	TRU-033-A	HD-500
.524	.583	TRU-034-A	HD-562
.573	.634	TRU-035-A	HD-625
.622	.681	TRU-036-A	HD-656
.672	.730	TRU-037-A	HD-687
.721	.780	TRU-038-A	HD-750
.772	.830	TRU-039-A	HD-812
.833	.880	TRU-041-A	HD-859
.872	.930	TRU-042-A	HD-906
.922	.980	TRU-043-A	HD-937
.972	1.036	TRU-044-A	HD-1.000
1.022	1.080	TRU-045-A	HD-1.046
1.072	1.130	TRU-046-A	HD-1.109
1.130	1.220	TRU-051-A	HD-1.187
1.210	1.300	TRU-052-A	HD-1.250
1.290	1.380	TRU-053-A	HD-1.343
1.370	1.460	TRU-054-A	HD-1.437
1.450	1.540	TRU-055-A	HD-1.500
1.530	1.620	TRU-056-A	HD-1.578